

Great Yarmouth Third River Crossing

Application for Development Consent Order

Document 2.6: Works Plans

Planning Act 2008

The Infrastructure Planning (Applications: Prescribed Forms and Procedure) Regulations 2009 (as amended) (“APFP”)

APFP regulation Number: 5(2)(j)

Planning Inspectorate Reference Number: TR010043

Author: Norfolk County Council

Document Reference: 2.6

Version Number: P00

Date: 30th April 2019

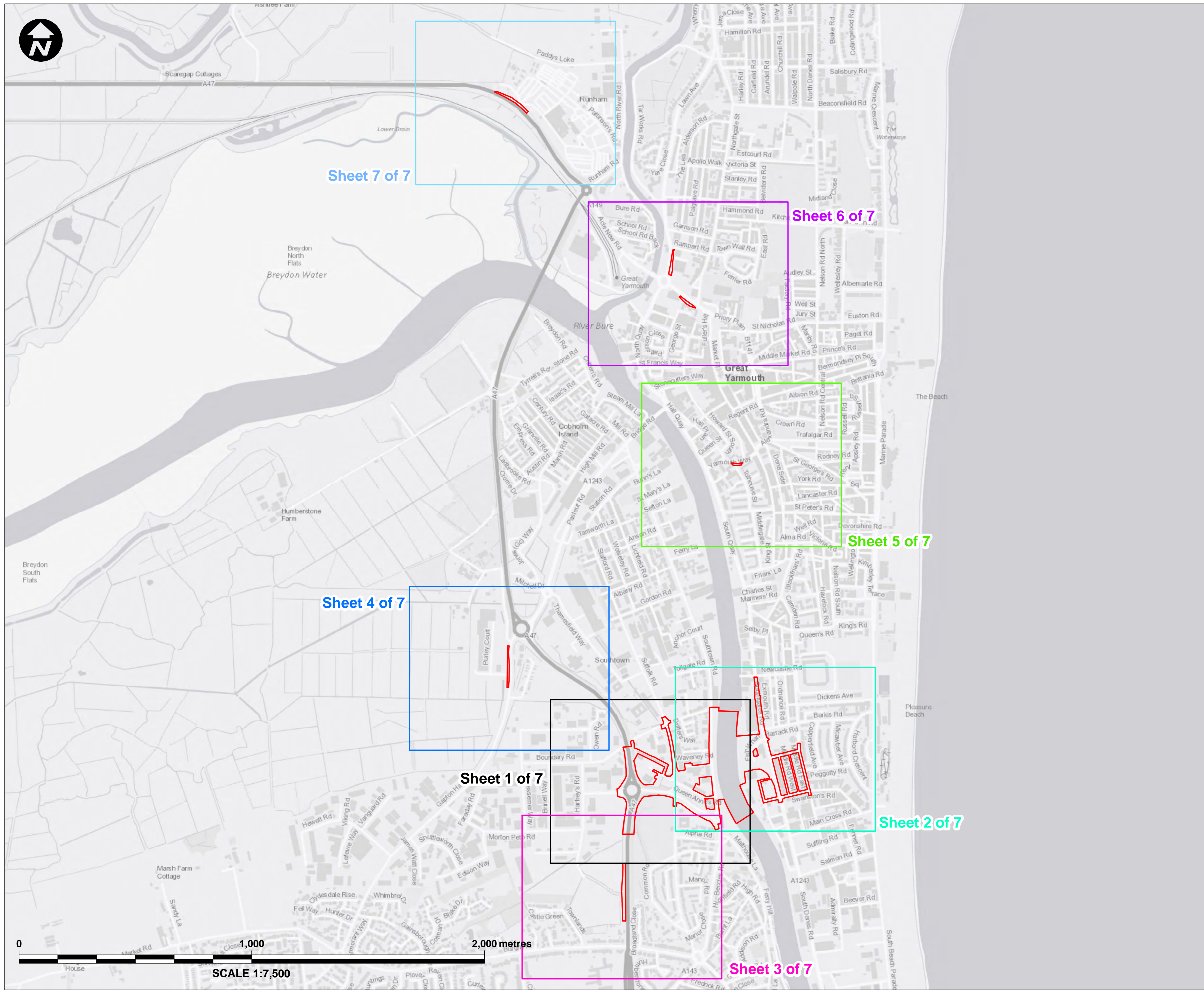

Key:

	Order Limits
	Sheet 1 of 7
	Sheet 2 of 7
	Sheet 3 of 7
	Sheet 4 of 7
	Sheet 5 of 7
	Sheet 6 of 7
	Sheet 7 of 7

NOTES:
1. This plan should be read in conjunction with the Development Consent Order and the documents it refers to.

Mapping reproduced by permission of Ordnance Survey on behalf of HMSO.
© Crown copyright and database rights 2018 Ordnance Survey 100019340.

REVISION	DRAWN	CHECKED	APPROVED	DATE

Norfolk County Council
Tom McCabe
Executive Director of
Community and Environmental Services
Norfolk County Council
County Hall, Martineau Lane
Norwich NR1 2SG

PROJECT TITLE
**GREAT YARMOUTH
THIRD RIVER CROSSING**

DRAWING TITLE
DCO DOCUMENT 2.6
WORKS PLANS
KEY PLAN
(REGULATION 5(2)(j) & 5(4))

DRAWING STATUS
FOR DCO APPLICATION

DRAWN	CHECKED	APPROVED	AUTHORISED
DE	MO	AG	MK

SCALE @ A1 SIZE: 1:7,500 DATE: 11/04/2019 REVISION: P00

DRAWING NUMBER
GYTRC-WSP-HGN-XX-DR-CB-1023

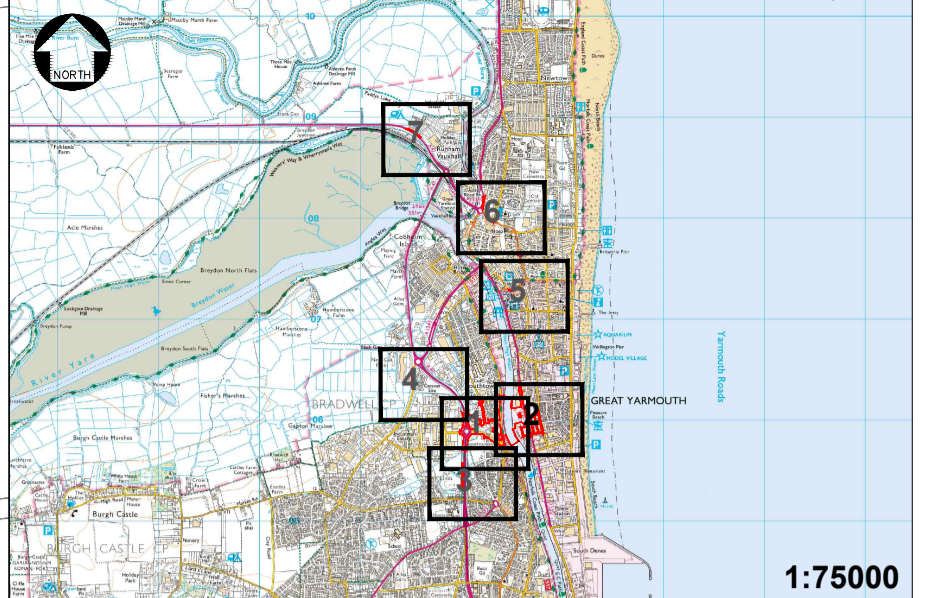
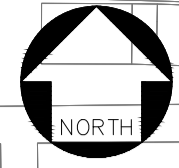

Key:

- Order Limits
- Area excluded from Order Limits
- Start / End of Linear Work
- Linear Work Centre Line
- Non-Linear Work Limit of Deviation
- Area of Deemed Marine Licence
- Point reference to co-ordinates identifying the area to which the deemed marine licence relates

Notes:

- The numbered linear and non-linear works are references to the works in Schedule 1 (Authorised Development) to the Development Consent Order.
- This plan should be read in conjunction with the Development Consent Order (DCO) and the documents it refers to, in particular the DCO article entitled 'Limits of Deviation' and DCO Schedule 1 (Authorised Development).

Mapping reproduced by permission of Ordnance Survey on behalf of HMSO.
© Crown copyright and database rights 2018 Ordnance Survey 100019340.

REVISION	DRAWN	CHECKED	APPROVED	DATE

Norfolk County Council
 Tom McCabe
 Executive Director of
 Community and Environmental Services
 Norfolk County Council
 County Hall, Martineau Lane
 Norwich NR1 2SG

PROJECT TITLE
 GREAT YARMOUTH
 THIRD RIVER CROSSING

DRAWING TITLE
 DCO DOCUMENT 2.6
 WORKS PLAN
 SHEET 1 OF 7
 (REGULATION 5(2)(j))

DRAWING STATUS
 FOR DCO APPLICATION

JC	MO	AG	MK
1:1250	12/04/2019	P00	

GYTRC-WSP-HGN-XX-DR-CB-1024

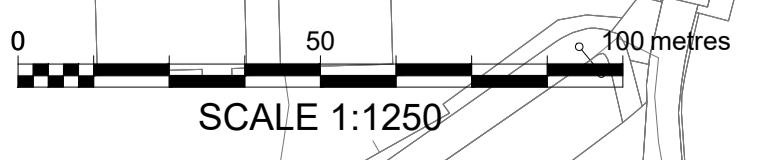
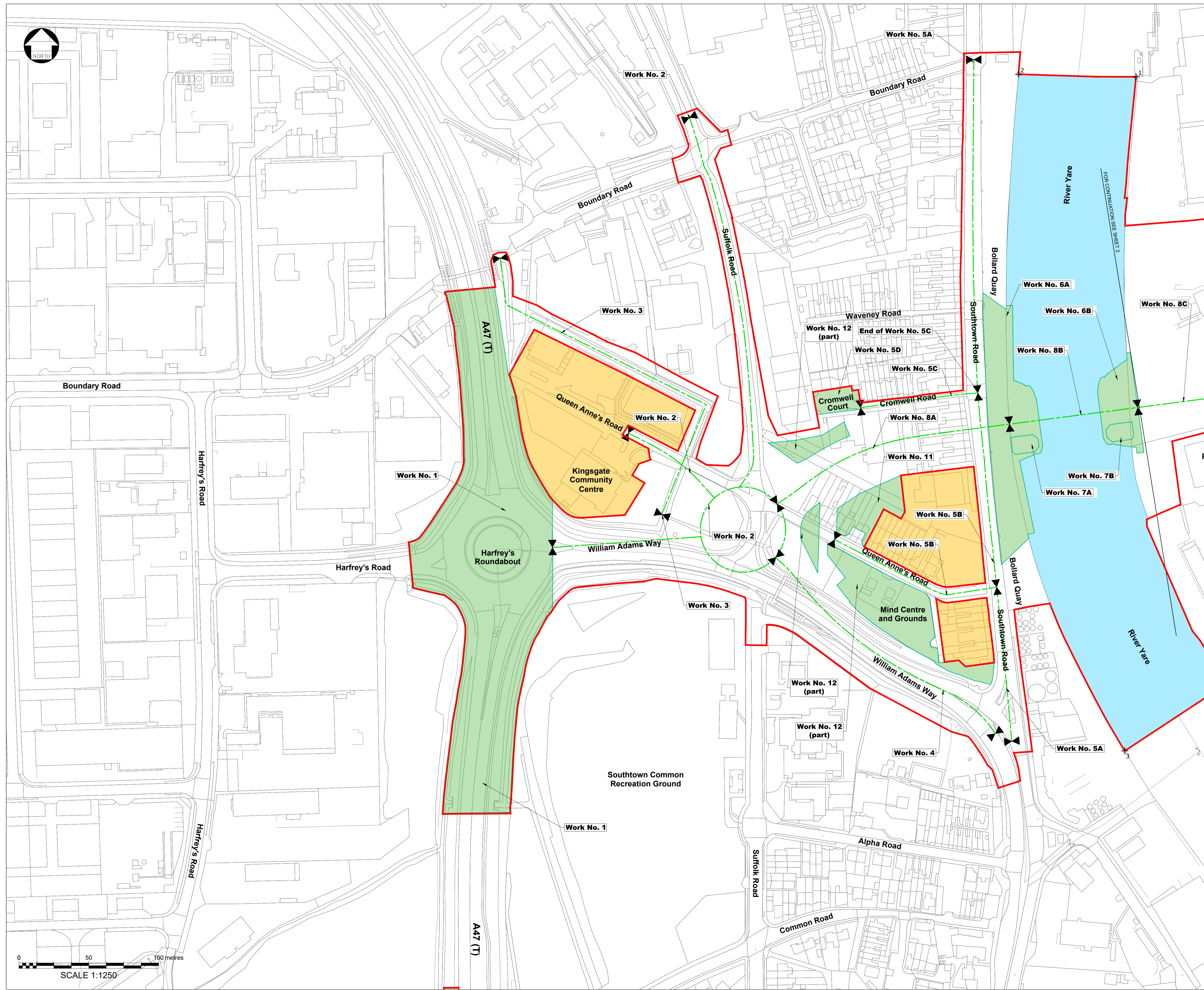

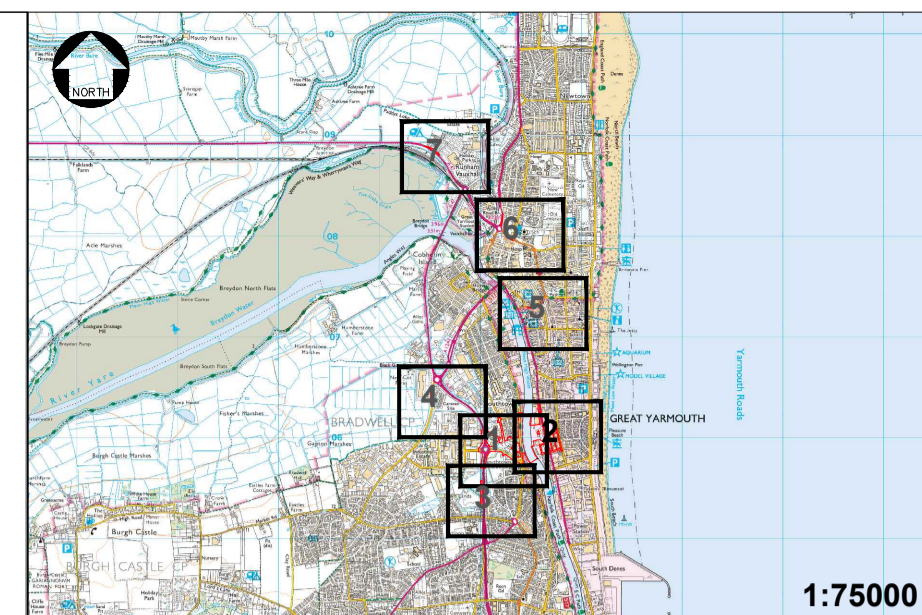
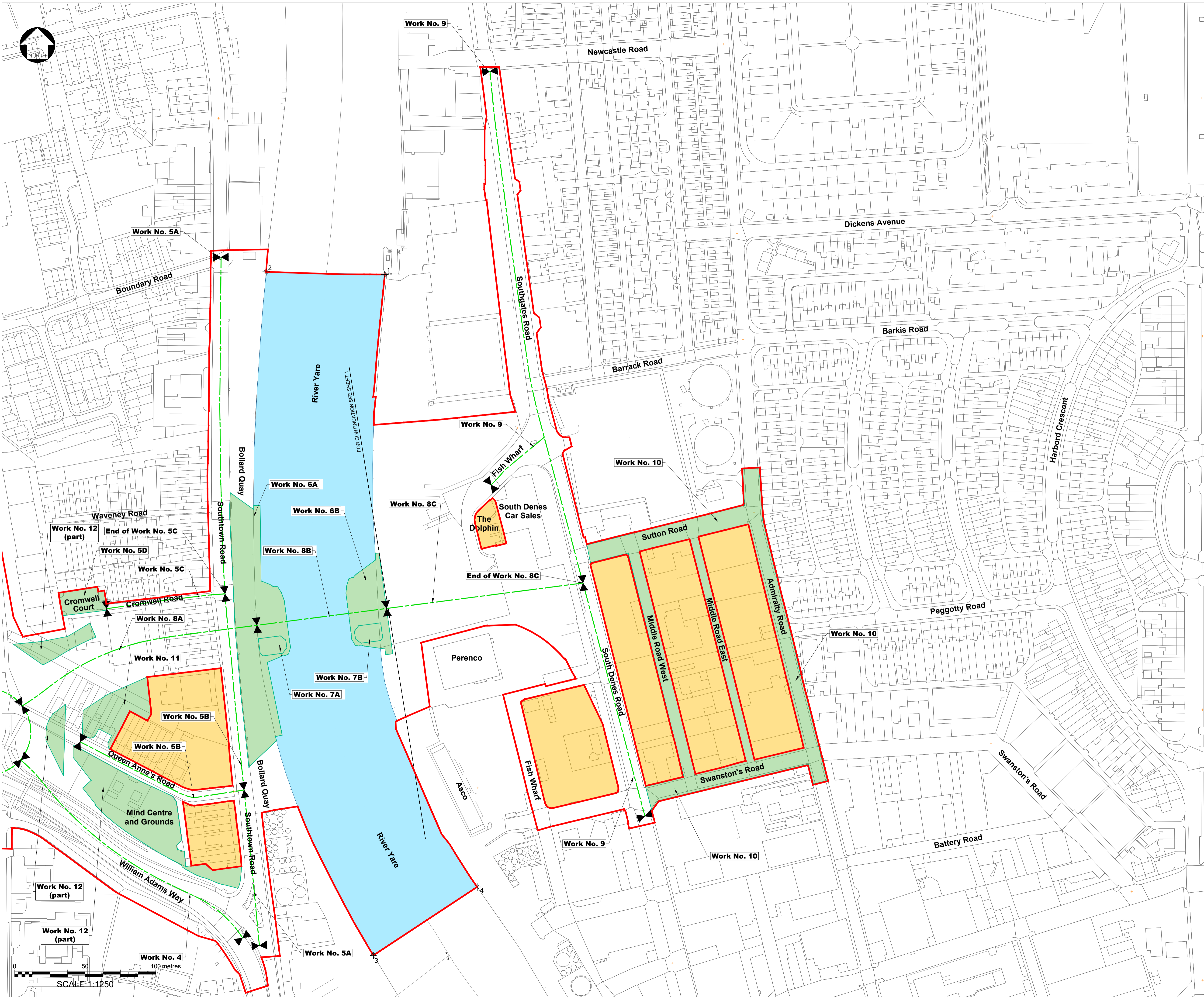

Key:

- Order Limits
- Area excluded from Order Limits
- Start / End of Linear Work
- Linear Work Centre Line
- Non-Linear Work Limit of Deviation
- Area of Deemed Marine Licence
- + Point reference to co-ordinates identifying the area to which the deemed marine licence relates

Notes:

- The numbered linear and non-linear works are references to the works in Schedule 1 (Authorised Development) to the Development Consent Order.
- This plan should be read in conjunction with the Development Consent Order (DCO) and the documents it refers to, in particular the DCO article entitled 'Limits of Deviation' and DCO Schedule 1 (Authorised Development).

Mapping reproduced by permission of Ordnance Survey on behalf of HMSO.
 © Crown copyright and database rights 2018 Ordnance Survey 100019340.

REVISION	DRAWN	CHECKED	APPROVED	DATE

Norfolk County Council
 Tom McCabe
 Executive Director of
 Community and Environmental Services
 Norfolk County Council
 County Hall, Martineau Lane
 Norwich NR1 2SG

PROJECT TITLE
 GREAT YARMOUTH
 THIRD RIVER CROSSING

DRAWING TITLE
 DCO DOCUMENT 2.6
 WORKS PLAN
 SHEET 2 OF 7
 (REGULATION 5(2)(j))

DRAWING STATUS
 FOR DCO APPLICATION

JC	MO	AG	MK
1:1250	12/04/2019	P00	

GYTRC-WSP-HGN-XX-DR-CB-1025

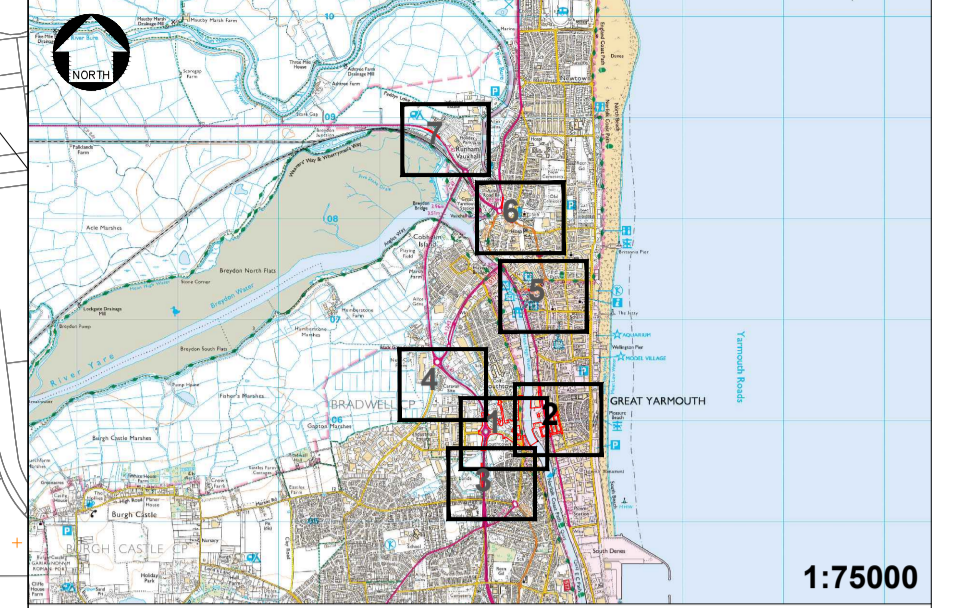
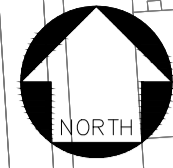

1:75000

Southtown Common Recreation Ground

Work No. 1

Work No. 12 (part)

Work No. 4

A47 (T)

Work No. 13A

Suffolk Road

Alpha Road

Common Road

Beccles Road

Castle Green

Tomlans





Harrey's Road

Burgh Road

Burgh Road

0 50 100 metres

SCALE 1:1250

- Key:**
-  Order Limits
 -  Start / End of Linear Work
 -  Linear Work Centre Line
 -  Non-Linear Work Limit of Deviation

- Notes:**
1. The numbered linear and non-linear works are references to the works in Schedule 1 (Authorised Development) to the Development Consent Order.
 2. This plan should be read in conjunction with the Development Consent Order (DCO) and the documents it refers to, in particular the DCO article entitled 'Limits of Deviation' and DCO Schedule 1 (Authorised Development).

Mapping reproduced by permission of Ordnance Survey on behalf of HMSO.
 © Crown copyright and database rights 2018 Ordnance Survey 100019340.

REVISION	DRAWN	CHECKED	APPROVED	DATE

Norfolk County Council
 Tom McCabe
 Executive Director of
 Community and Environmental Services
 Norfolk County Council
 County Hall, Marlineau Lane
 Norwich NR1 2SG

PROJECT TITLE
 GREAT YARMOUTH
 THIRD RIVER CROSSING

DRAWING TITLE
 DCO DOCUMENT 2.6
 WORKS PLAN
 SHEET 3 OF 7
 (REGULATION 5(2)(j))

DRAWING STATUS
 FOR DCO APPLICATION

JC	MO	AG	MK
1:1250	12/04/2019	P00	

GYTRC-WSP-HGN-XX-DR-CB-1026

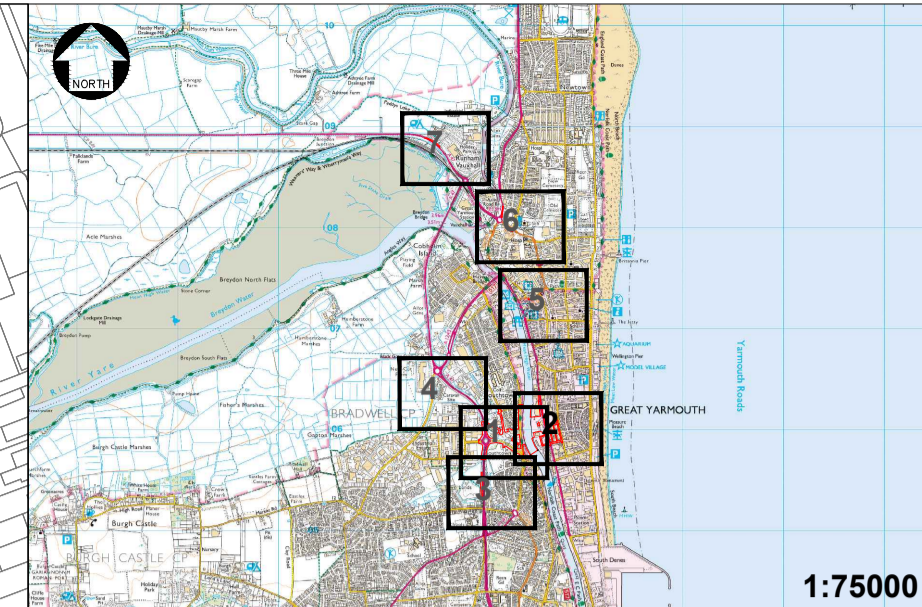
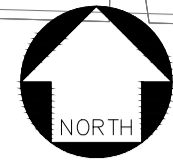

Key:

- Order Limits
- Non-Linear Work Limit of Deviation

Notes:

1. The numbered linear and non-linear works are references to the works in Schedule 1 (Authorised Development) to the Development Consent Order.
2. This plan should be read in conjunction with the Development Consent Order (DCO) and the documents it refers to, in particular the DCO article entitled 'Limits of Deviation' and DCO Schedule 1 (Authorised Development).

Mapping reproduced by permission of Ordnance Survey on behalf of HMSO.
© Crown copyright and database rights 2018 Ordnance Survey 100019340.

REVISION	DRAWN	CHECKED	APPROVED	DATE

Norfolk County Council
 Tom McCabe
 Executive Director of
 Community and Environmental Services
 Norfolk County Council
 County Hall, Martineau Lane
 Norwich NR1 2SG

PROJECT TITLE
 GREAT YARMOUTH
 THIRD RIVER CROSSING

DRAWING TITLE
 DCO DOCUMENT 2.6
 WORKS PLAN
 SHEET 4 OF 7
 (REGULATION 5(2)(j))

DRAWING STATUS
 FOR DCO APPLICATION

JC	MO	AG	MK
1:1250	12/04/2019	P00	

GYTRC-WSP-HGN-XX-DR-CB-1027

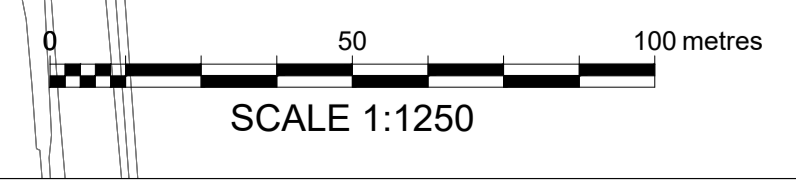

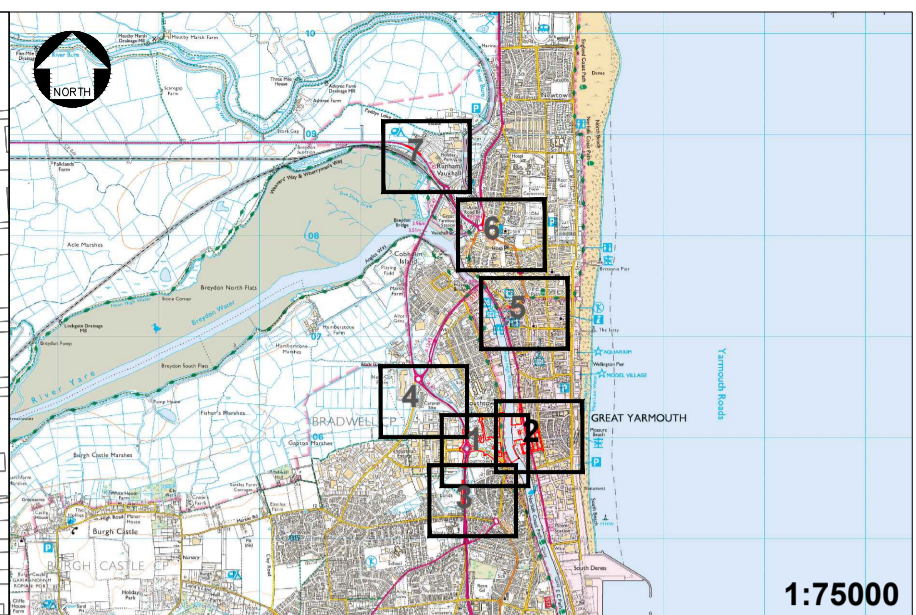
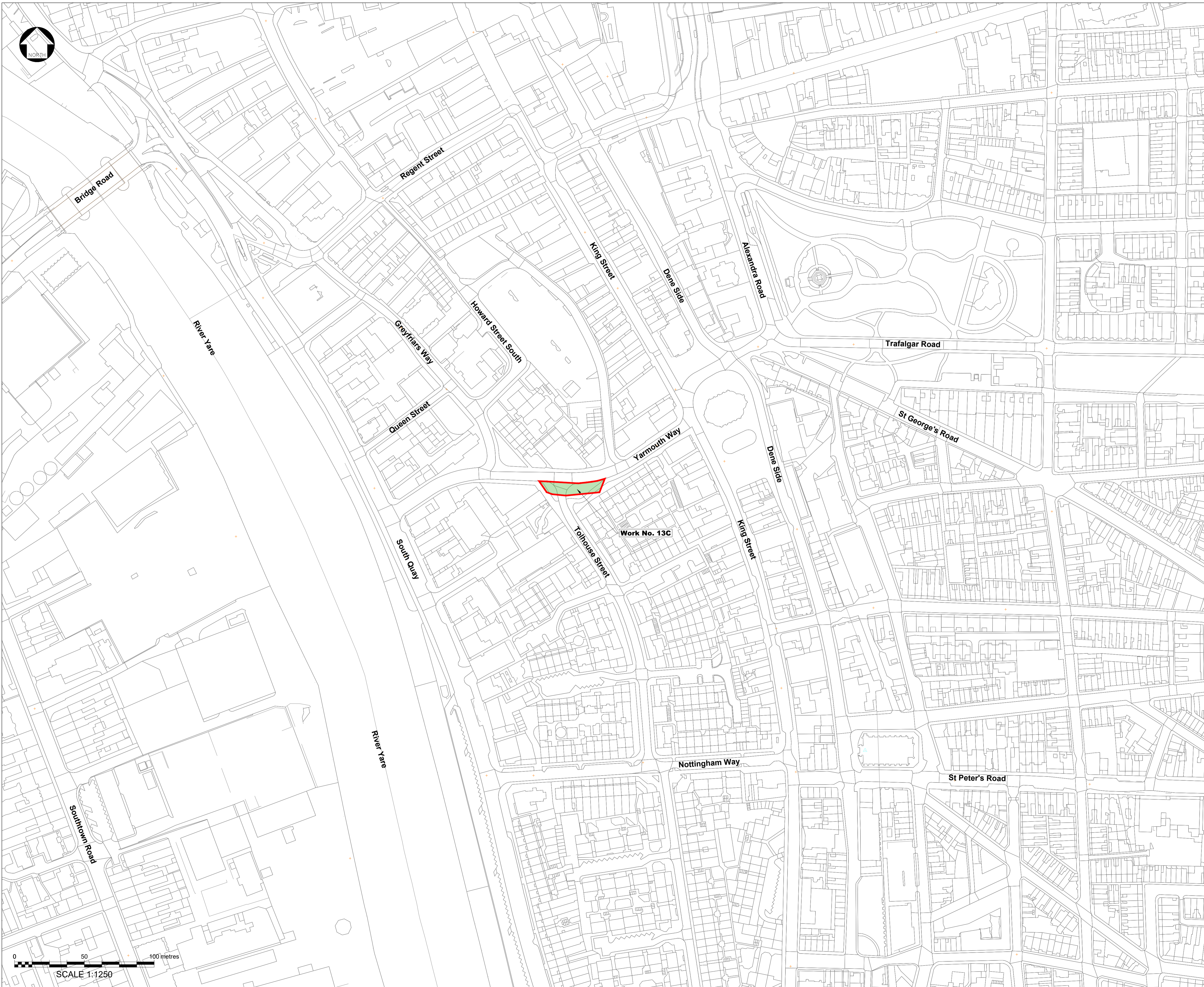

Key:

	Order Limits
	Non-Linear Work Limit of Deviation

- Notes:**
1. The numbered linear and non-linear works are references to the works in Schedule 1 (Authorised Development) to the Development Consent Order.
 2. This plan should be read in conjunction with the Development Consent Order (DCO) and the documents it refers to, in particular the DCO article entitled 'Limits of Deviation' and DCO Schedule 1 (Authorised Development).

Mapping reproduced by permission of Ordnance Survey on behalf of HMSO.
 © Crown copyright and database rights 2018 Ordnance Survey 100019340.

REVISION	DRAWN	CHECKED	APPROVED	DATE
DESCRIPTION				

Norfolk County Council
 Tom McCabe
 Executive Director of
 Community and Environmental Services
 Norfolk County Council
 County Hall, Martineau Lane
 Norwich NR1 2SG

PROJECT TITLE
**GREAT YARMOUTH
 THIRD RIVER CROSSING**

DRAWING TITLE
 DCO DOCUMENT 2.6
 WORKS PLAN
 SHEET 5 OF 7
 (REGULATION 5(2)(j))

DRAWING STATUS
 FOR DCO APPLICATION

JC	MO	AG	MK
1:1250	12/04/2019	P00	

GYTRC-WSP-HGN-XX-DR-CB-1028

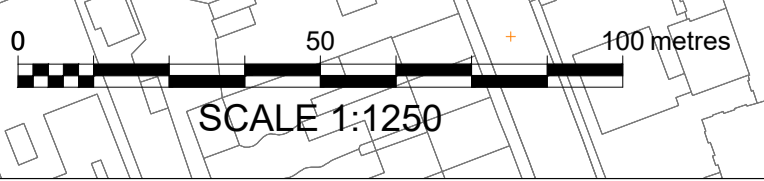
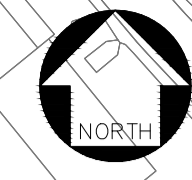

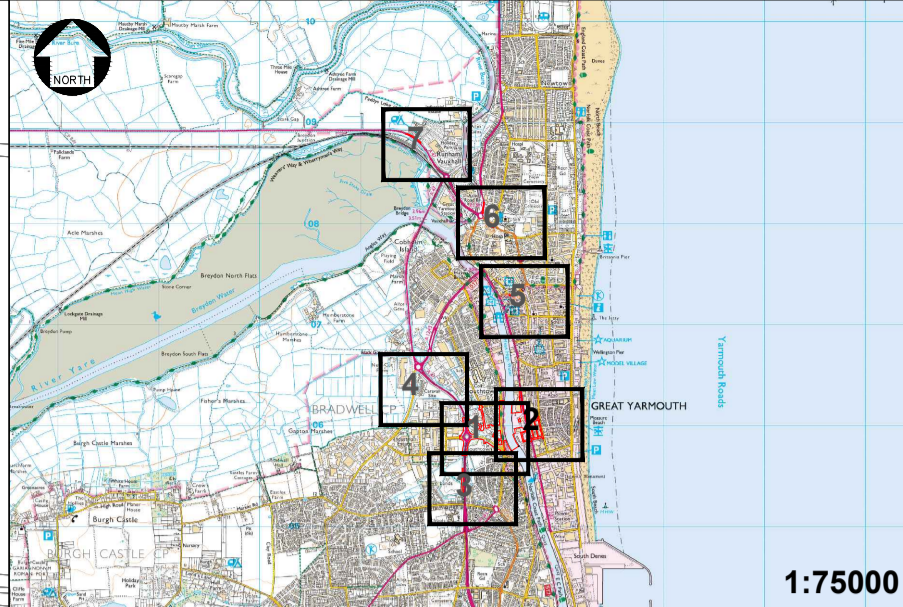
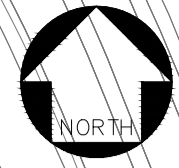

1:75000

Key:



Order Limits

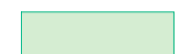

Non-Linear Work Limit of Deviation

Notes:

1. The numbered linear and non-linear works are references to the works in Schedule 1 (Authorised Development) to the Development Consent Order.
2. This plan should be read in conjunction with the Development Consent Order (DCO) and the documents it refers to, in particular the DCO article entitled 'Limits of Deviation' and DCO Schedule 1 (Authorised Development).

Mapping reproduced by permission of Ordnance Survey on behalf of HMSO.
 © Crown copyright and database rights 2018 Ordnance Survey 100019340.

REVISION	DRAWN	CHECKED	APPROVED	DATE

Norfolk County Council
 Tom McCabe
 Executive Director of
 Community and Environmental Services
 Norfolk County Council
 County Hall, Marlineau Lane
 Norwich NR1 2SG

PROJECT TITLE
**GREAT YARMOUTH
 THIRD RIVER CROSSING**

DRAWING TITLE
 DCO DOCUMENT 2.6
 WORKS PLAN
 SHEET 6 OF 7
 (REGULATION 5(2)(j))

DRAWING STATUS
 FOR DCO APPLICATION

JC	MO	AG	MK
1:1250	12/04/2019	P00	

GYTRC-WSP-HGN-XX-DR-CB-1029

0 50 100 metres
 SCALE 1:1250



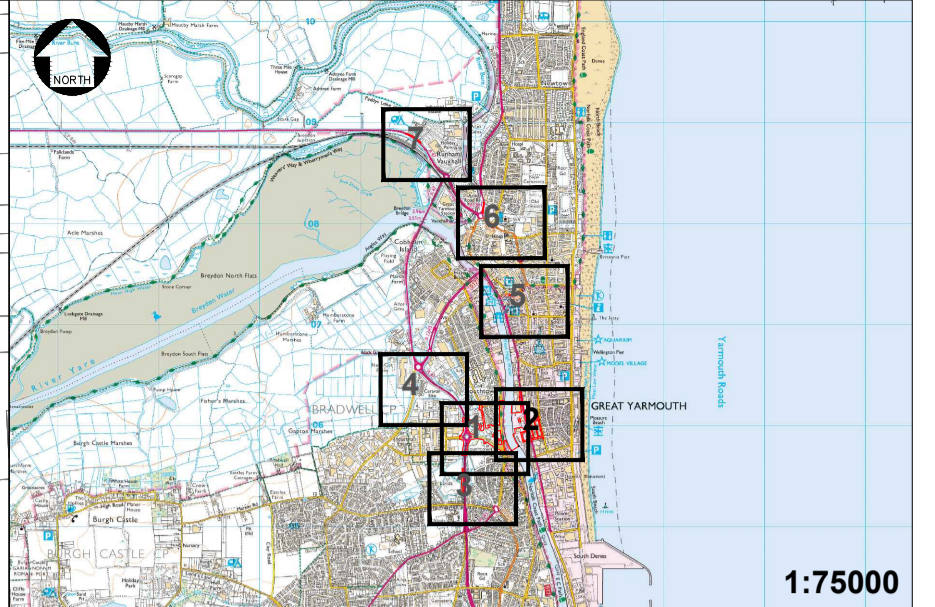
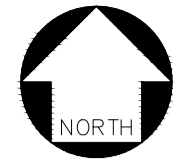

- Key:**
- Order Limits
 - Non-Linear Work Limit of Deviation

- Notes:**
1. The numbered linear and non-linear works are references to the works in Schedule 1 (Authorised Development) to the Development Consent Order.
 2. This plan should be read in conjunction with the Development Consent Order (DCO) and the documents it refers to, in particular the DCO article entitled 'Limits of Deviation' and DCO Schedule 1 (Authorised Development).

Mapping reproduced by permission of Ordnance Survey on behalf of HMSO.
 © Crown copyright and database rights 2018 Ordnance Survey 100019340.

REVISION	DRAWN	CHECKED	APPROVED	DATE

Norfolk County Council
 Tom McCabe
 Executive Director of
 Community and Environmental Services
 Norfolk County Council
 County Hall, Marlineau Lane
 Norwich NR1 2SG

PROJECT TITLE
 GREAT YARMOUTH
 THIRD RIVER CROSSING

DRAWING TITLE
 DCO DOCUMENT 2.6
 WORKS PLAN
 SHEET 7 OF 7
 (REGULATION 5(2)(j))

DRAWING STATUS
 FOR DCO APPLICATION

JC	MO	AG	MK
1:1250	12/04/2019	P00	

GYTRC-WSP-HGN-XX-DR-CB-1030

A47 (T) Acle New Road

Work No. 13F

Vauxhall Holiday Park

Pattinson's Road

0 50 100 metres
 SCALE 1:1250